

MEMS Variable Optical Attenuator



Key Features

- Low IL, Low PDL, Low WDL
- Fast Response
- Compact Package
- GR-1221 Qualified

Applications

- Optical Power Control/equalization
- Gain Tilt Control in EDFA
- Receiver Protection

Performance Specifications

Parameter	Specifications	
Operating Wavelength	1525nm to 1610nm	
Insertion Loss (Excluding Connector)	≤ 0.8dB	
Polarization Dependent Loss	@ 0dB	≤ 0.1dB
	@ 0 - 10dB	≤ 0.2dB
	@ 10 - 20dB	≤ 0.4dB
Wavelength Dependent Loss	@ 0dB	≤ 0.2dB
	@ 0 - 10dB	≤ 1.0dB
	@ 10 - 20dB	≤ 2.0dB
Temperature Dependent Loss	@ 0dB	≤ ± 0.1dB
	@ 0 - 10dB	≤ ± 1.0dB
	@ 10 - 20dB	≤ ± 2.0dB
Return loss (Without Connector)	≥ 45dB	
Repeatability	≤ 0.1dB	
Attenuation Range	≥ 35dB	
Response Time	≤ 5ms	
Operating Voltage	7V or 20V	
Optical Power	≤ 500mW	
Operating Temperature	-5 to +70°C	
Storage Temperature	-40 to +85°C	
Fiber Type	SMF-28 or SMF-28 XB	

Mechanical Dimensions (Bare Fiber)

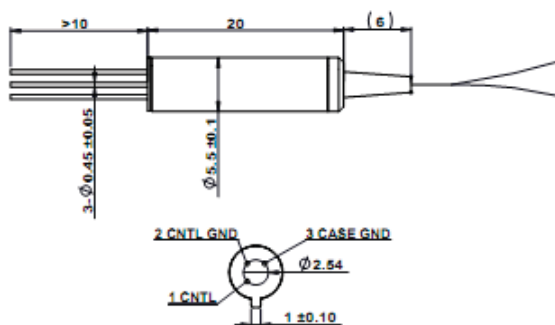

Mechanical Dimensions (900um Jacket)

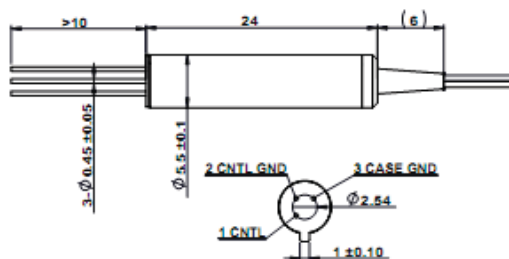

Ordering Information

EVOA	<input type="checkbox"/> <input type="checkbox"/>	<input type="checkbox"/>	<input type="checkbox"/>	<input type="checkbox"/>	<input type="checkbox"/>	<input type="checkbox"/>	<input type="checkbox"/> <input type="checkbox"/>
	Operating Wavelength	Off State	Voltage	Pigtail Style	Fiber Length	Fiber Type	In/Out Connector
	CL= C+L Band	T = Transparent 0 = Opaque	0 = 7V 1 = 20V	1 = Bare Fiber 2 = 900um Jacket	1 = 1.0m 2 = 2.0m	1 = SMF-28e 2 = G.657.A1	0 = None 1 = FC/APC 2 = FC/PC 3 = SC/APC 4 = SC/PC 5 = ST 6 = LC/UPC 7 = LC/APC